

Patterns for Children's Show

65 & 74

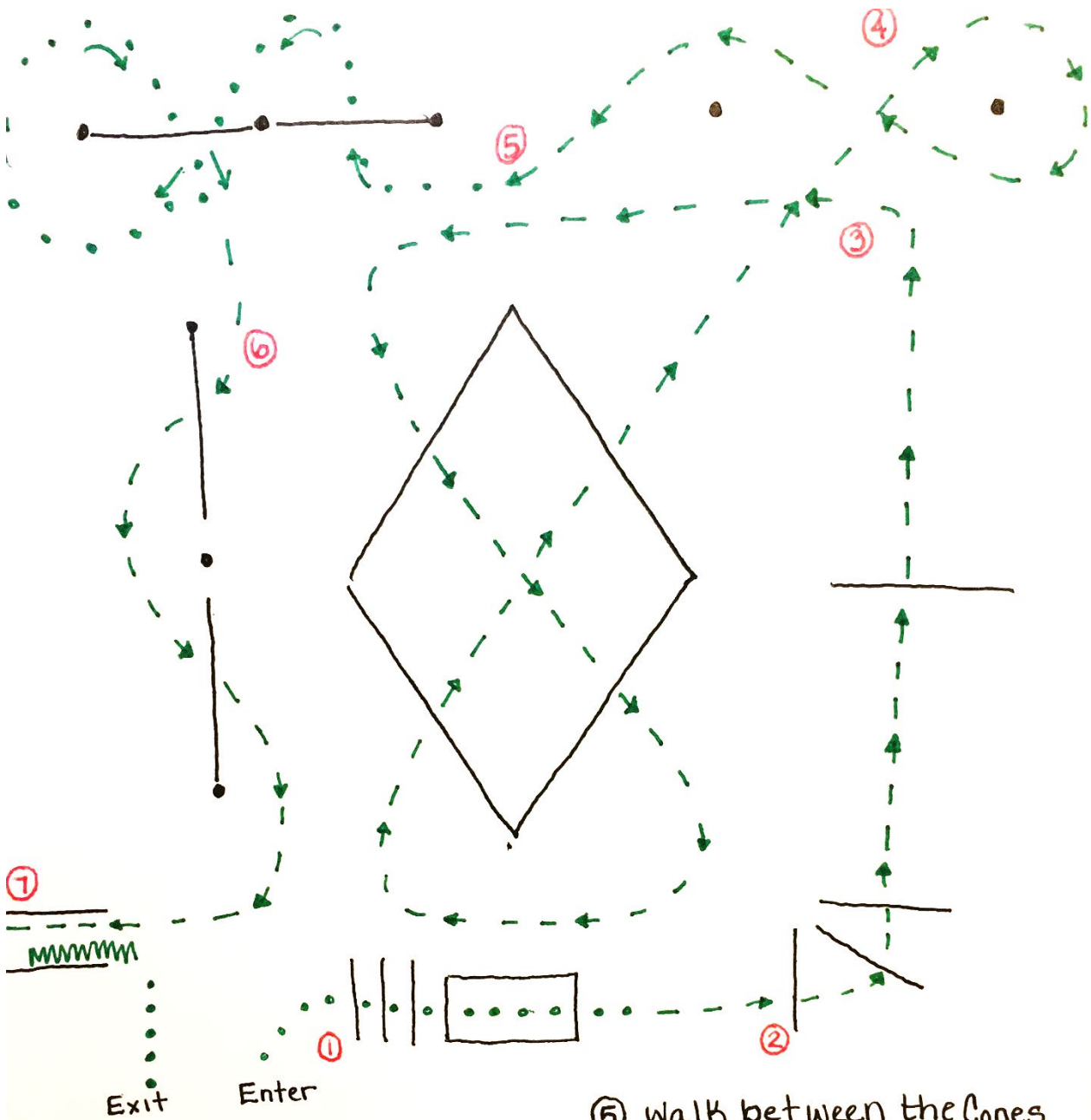

- ① Walk over logs and Bridge
- ② Trot/Jog over Fan Logs and Single rail.
- ③ Trot/Jog a Figure 8 down over logs.
- ④ Trot/Jog through Cones

- ⑤ Walk between the Cones and over logs.
- ⑥ Weave down over the two logs at the Trot/Jog.
- ⑦ Trot/Jog into chute Back out walk to exit.

Patterns for Children's Show

66 & 75

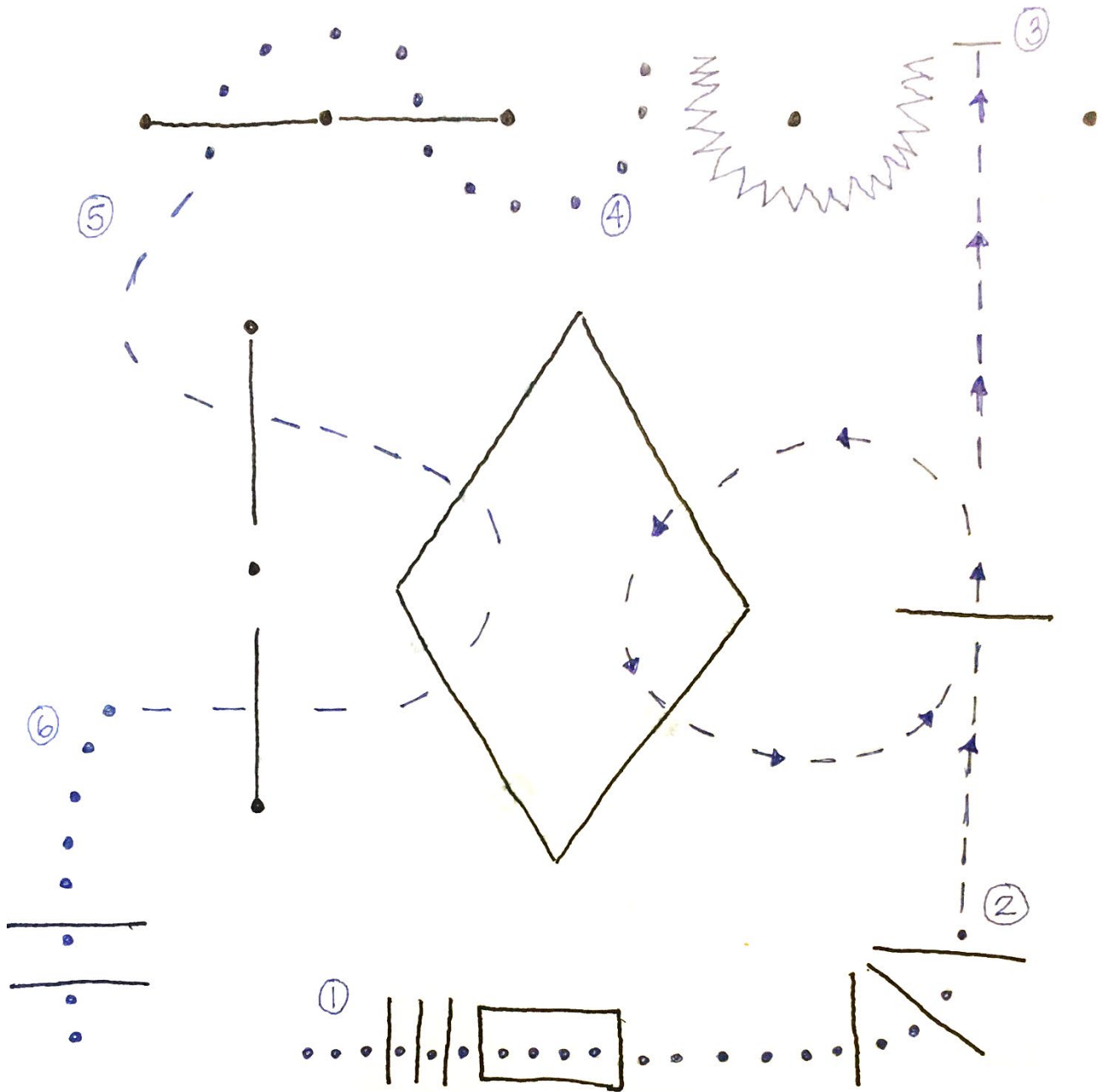

- ① Walk over logs, over Bridge, and over Fan logs.
- ② Trot/Jog over single rail, Trot/Jog a circle to the left around Corner of the Box, continue over single rail again to Cone.
- ③ Stop. Back around cone.
- ④ Weave Cones over logs at a walk
- ⑤ Weave Cones over logs, through Box at a Trot/Jog
- ⑥ Walk over last two rails and exit at a walk.

Children's Show

Lead Line Trail 16 & 22

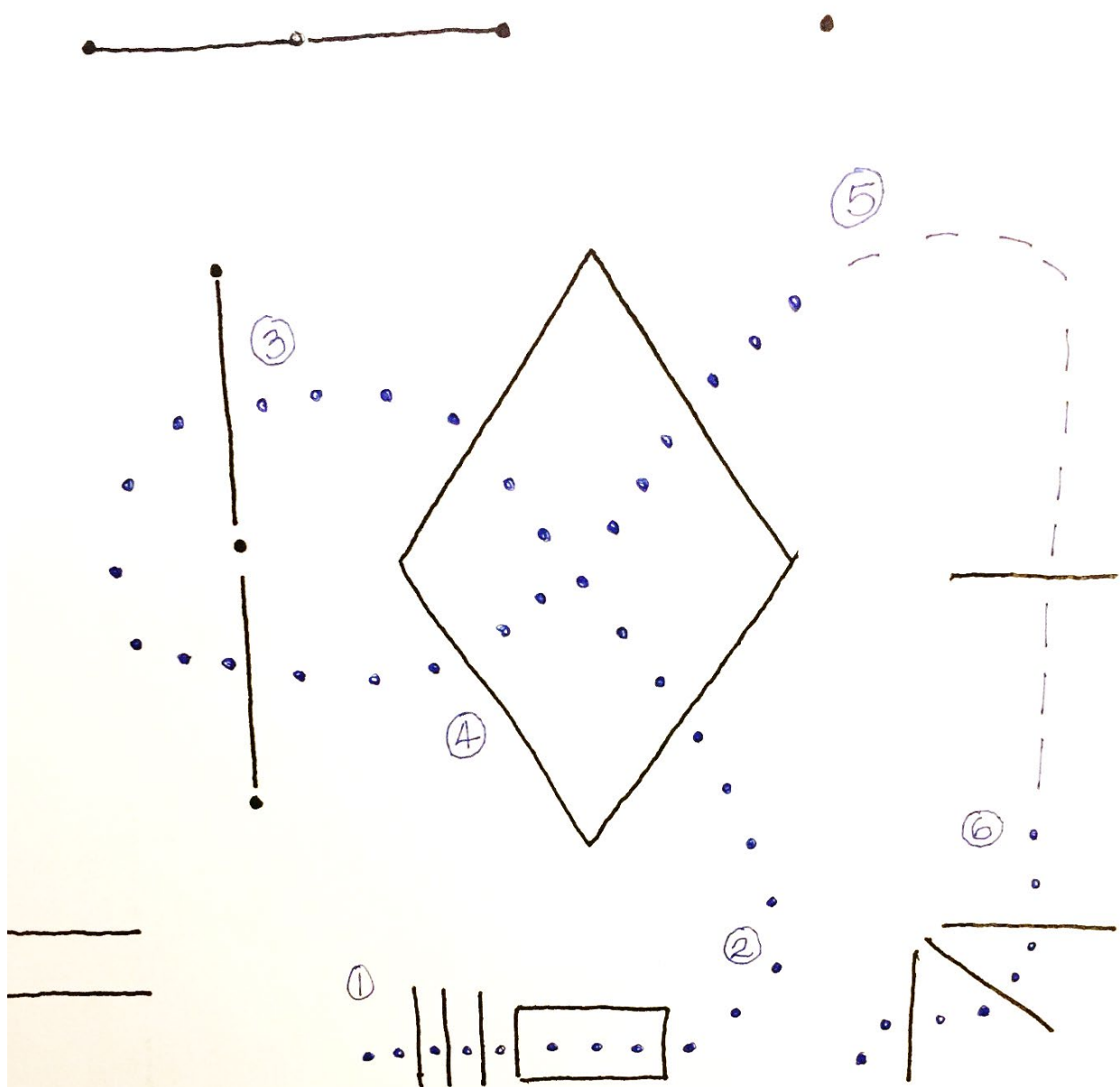

- ① walk over logs and Bridge.
- ② walk through the Box
- ③ weave through cones over logs at a walk.
- ④ walk Through the other side of the Box.
- ⑤ Trot or Jog over single rail.
- ⑥ walk down over the Fan logs.

Children's Show Ground Poles

Classes 37, 55, 58, 67, 76

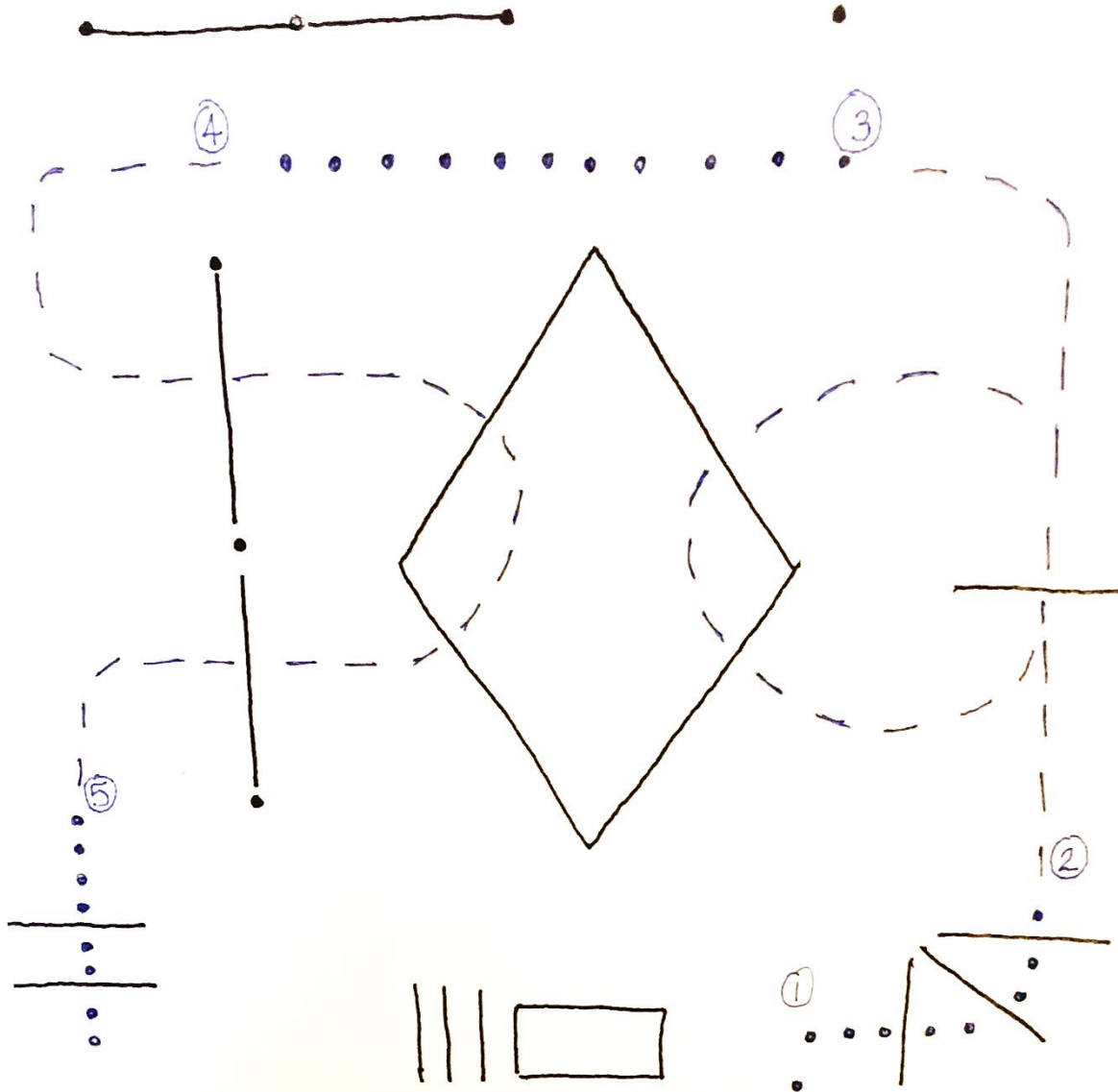

- ① Walk over Fan logs.
- ② Trot/Jog over single rail, Trot/Jog a circle to the left around the Corner of the Box, continue over single rail again headed towards the Cone.
- ③ Walk
- ④ Weave cones over logs, through Box at a Trot/Jog
- ⑤ Walk over two logs and exit at a walk.

Children's Show Patterns for classes

50, 53, 35, 36, 51, 54

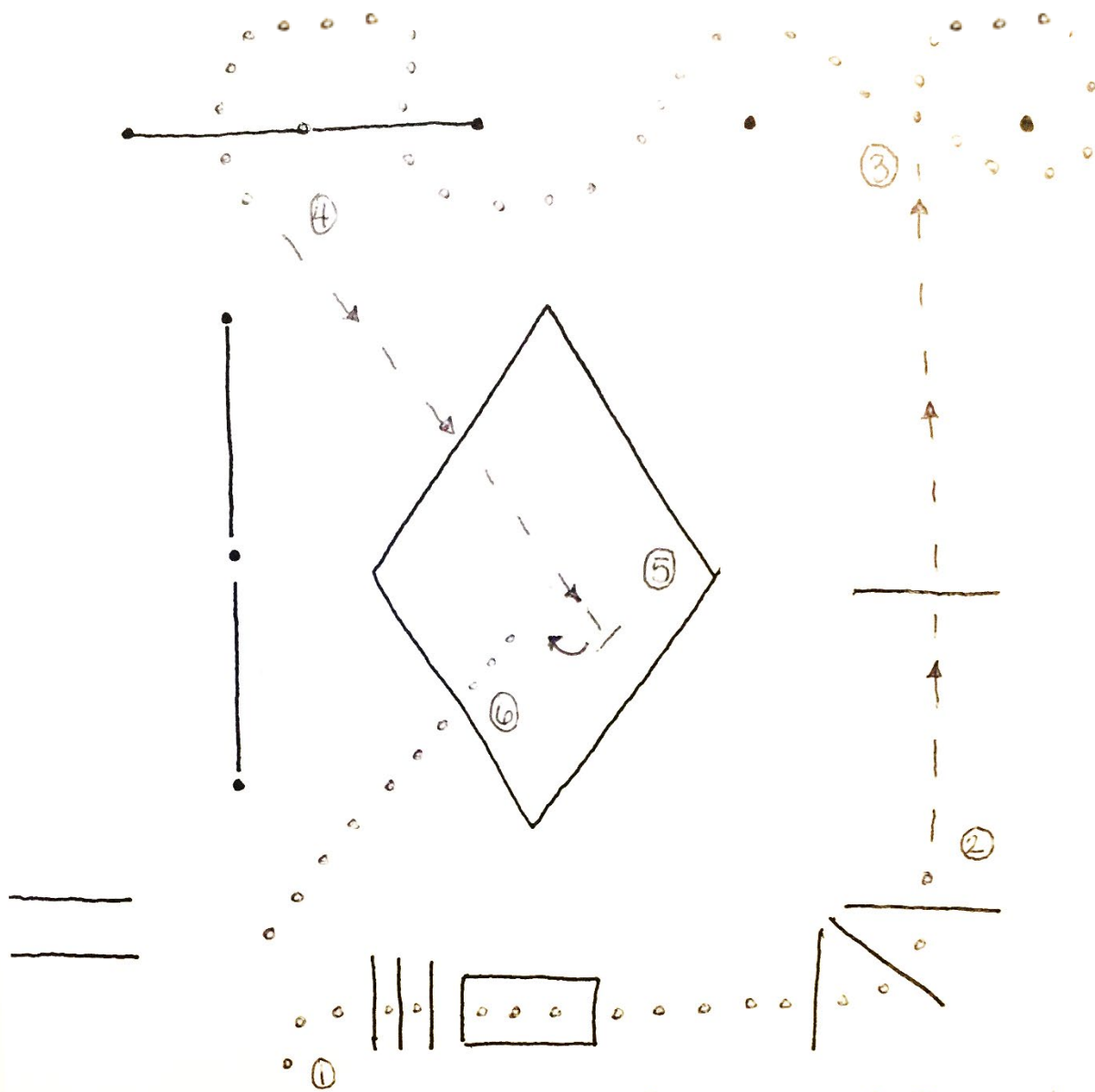

- ① Walk over logs, walk over Bridge And over Fan shape logs.
- ② Trot/Jog over logs to cones.
- ③ Weave the Cones at the walk.
- ④ Trot/Jog into Box, Stop.
- ⑤ Do a 90° turn to the Right.

⑥ Walk out of Box and to the exit.

Children's Show Ground Poles 18, 24, 52

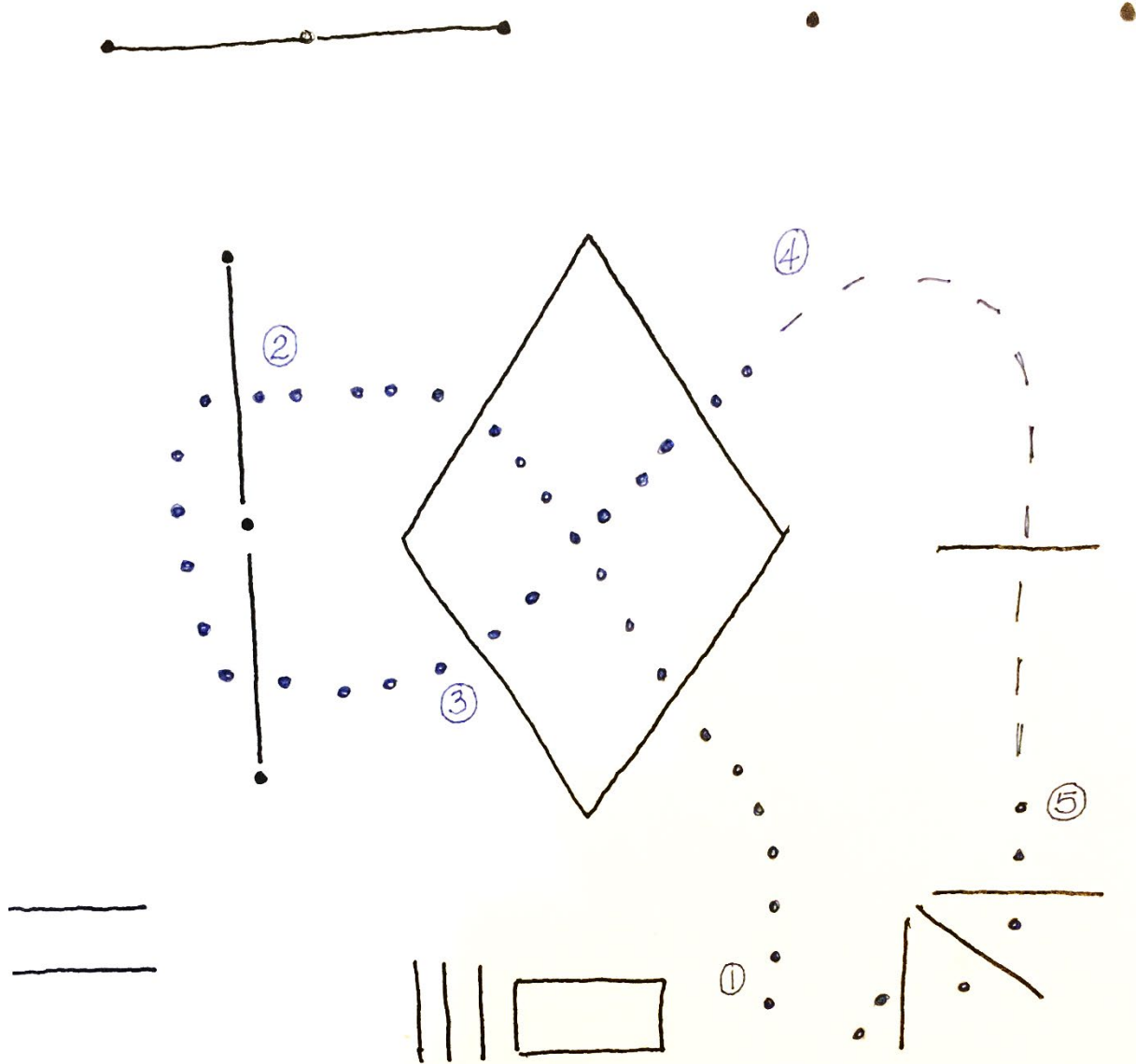

- ① walk through the Box
- ② weave through Cones over logs at a Walk.
- ③ walk through the other side of the Box.
- ④ Trot or jog single rail.
- ⑤ Walk down over the Fan Logs.