

Beginners Ground Poles

10 & Under Ground Poles

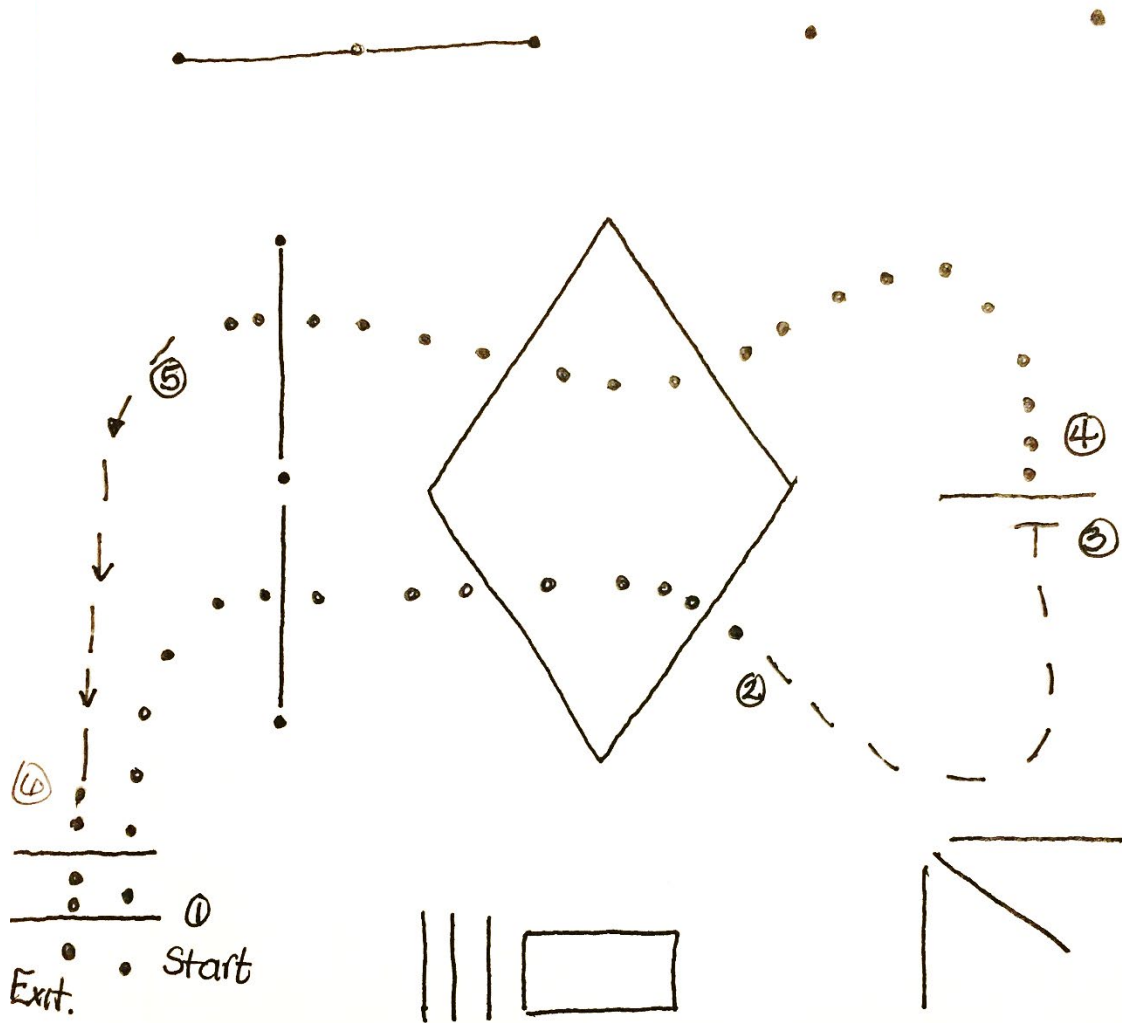

- ① walk over set of two legs, continue walking over single leg through the corner of the Box
- ② Trot/Jog to single leg.
- ③ Stop, pause for Couple Seconds
- ④ walk over leg through corner of Box to the single leg
- ⑤ Trot/Jog to set of two legs.
- ⑥ walk over legs to exit.

Adult Ground Poles

Junior Ground Poles

Therapeutic Advanced Ground Poles

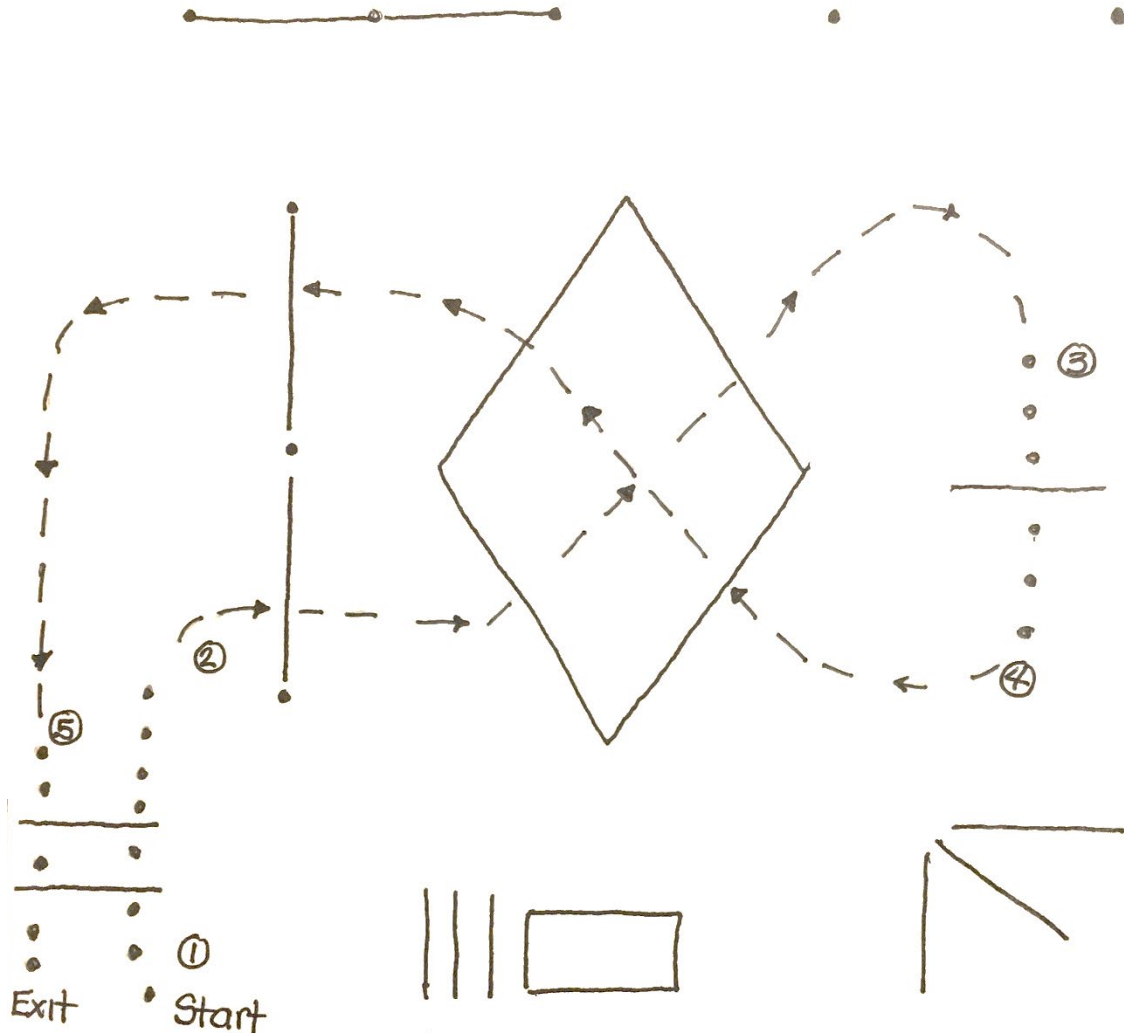

- ① walk over the two logs
- ② Trot/Jog over logs through Box to single log.
- ③ walk over single log.
- ④ Trot/Jog through box and over single log. Trot/Jog Back to the set of two logs.
- ⑤ walk over set of two logs to exit.

Adult Trail, Adult In Hand Trail
 Junior Trail, Junior In Hand Trail
 Senior Trail, Senior In Hand Trail
 Advanced Therapeutic Trail, Advanced Therapeutic In Hand Trail

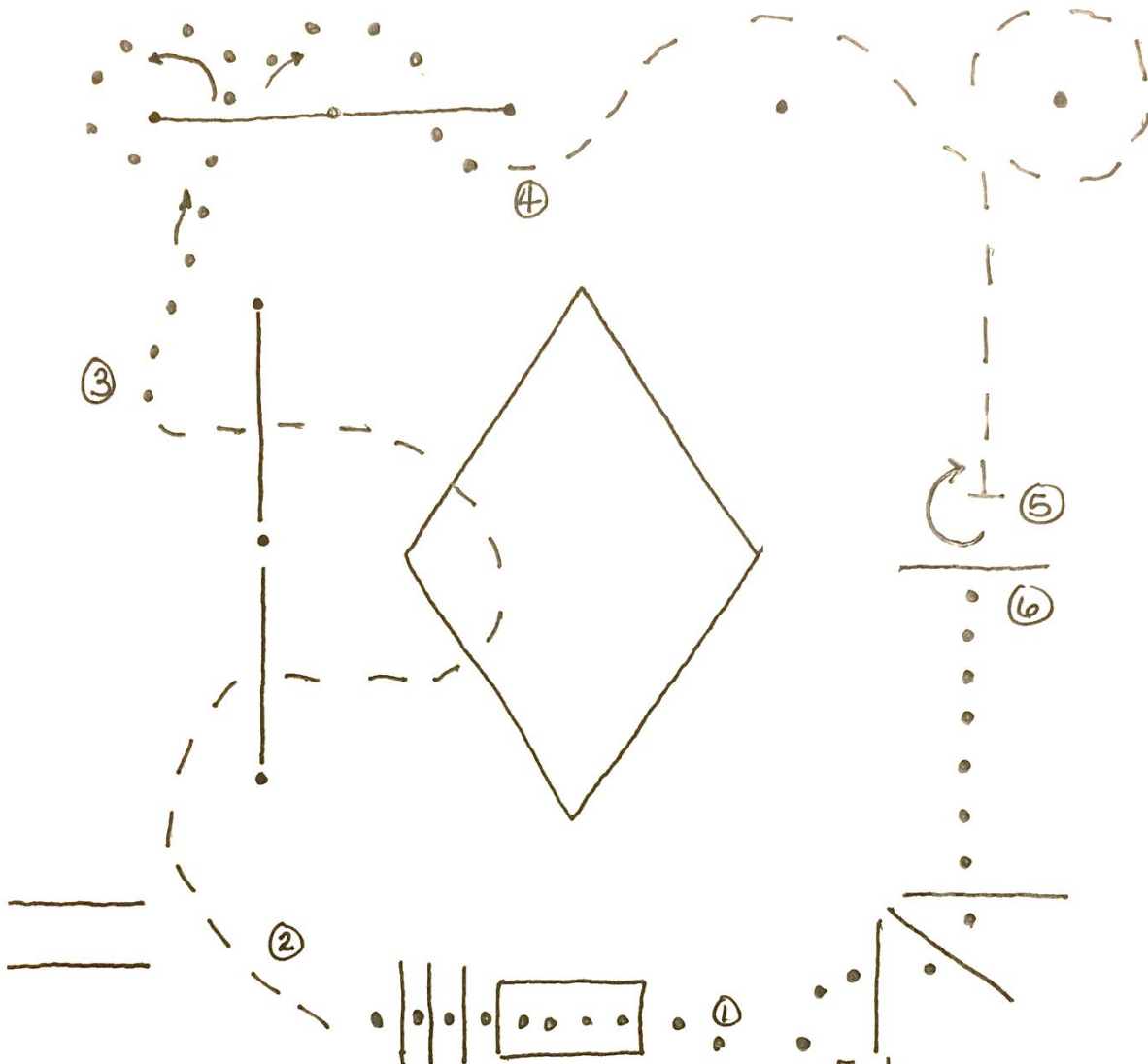

- ① Walk over Bridge and logs
- ② Trot/Jog over log over the corner of the Box to the next trail.
- ③ Walk and weave through Cones. Circling the 1st Cone to the LEFT FIRST.
- ④ Trot/Jog through the last two cones. Circling the last cone Trot/Jog to Single Log.
- ⑤ Stop, do 360° turn Right
- ⑥ Walk over log and Fan Logs to exit.

Ranch Trail

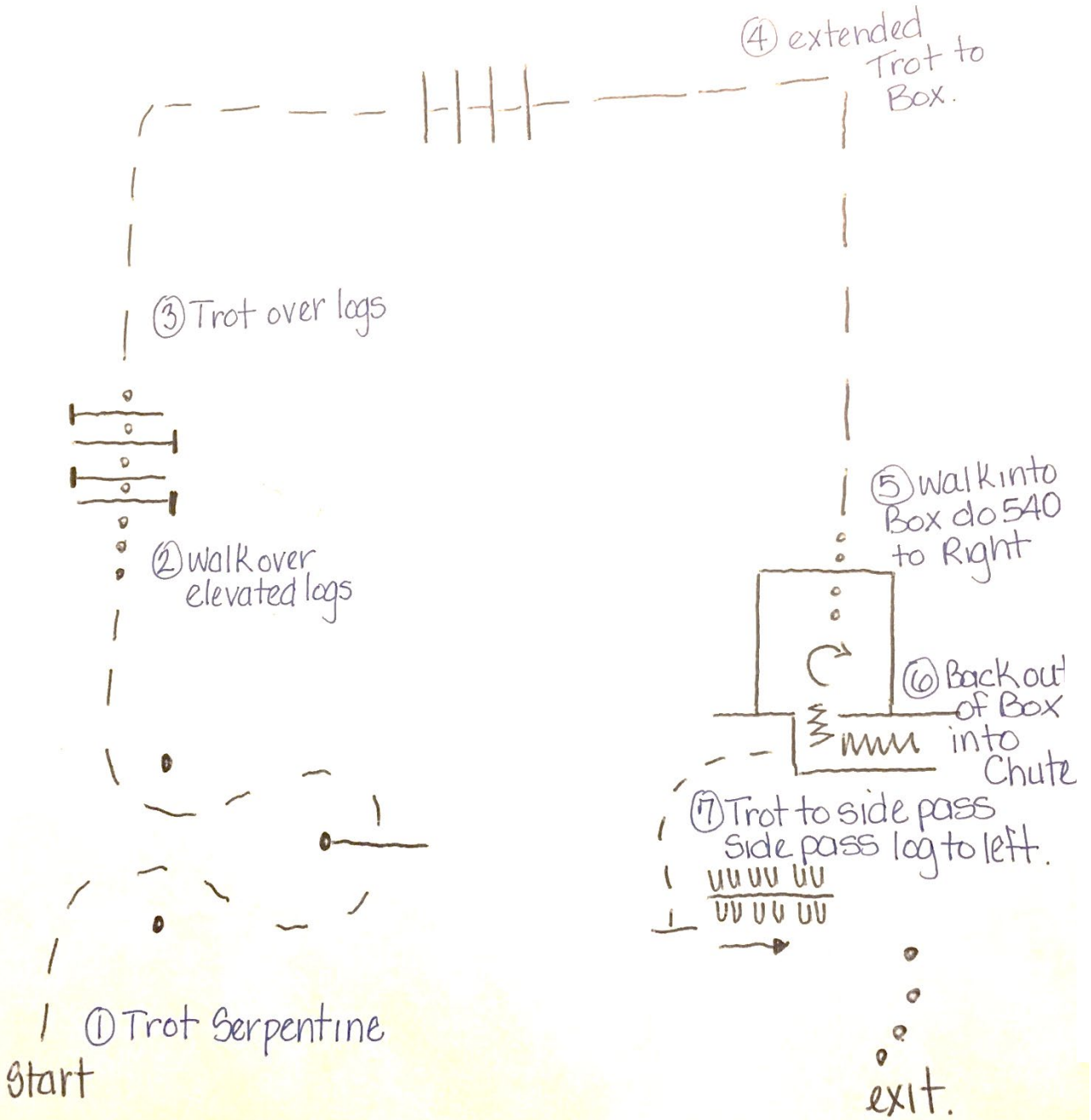

Lead Line Trail
Lead Line Trail In Hand
Therapeutic Maximum Trail
Therapeutic Maximum In Hand Trail

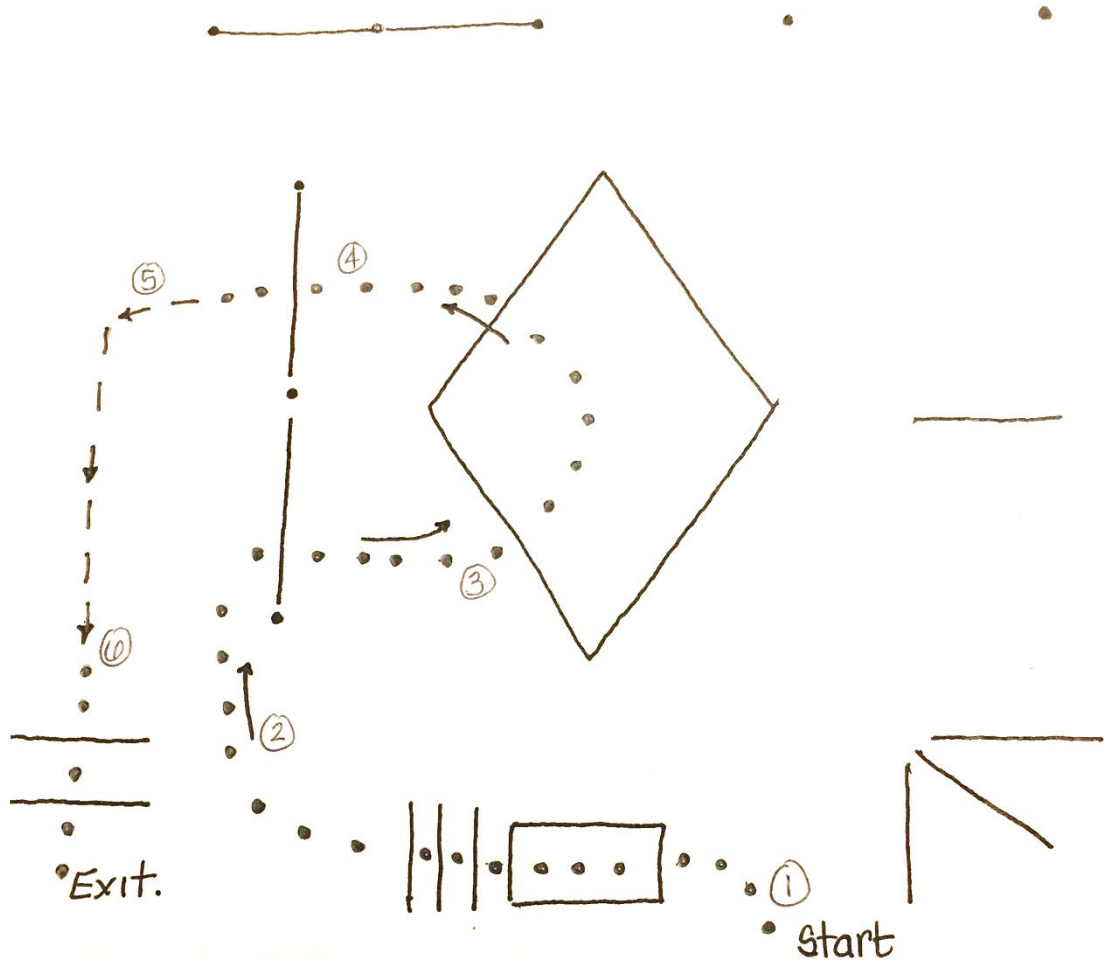

- ① Walk over Bridge, and poles
- ② Walk to and over single Log.
- ③ Walk through Corner of Box
- ④ Walk over single log.
- ⑤ Trot/Jog to the set of two logs
- ⑥ Walk over the two logs to exit.

Beginner Trail
 10 & Under Trail
 10 & Under In Hand Trail
 Therapeutic Minimum Trail
 Therapeutic Minimum In Hand Trail

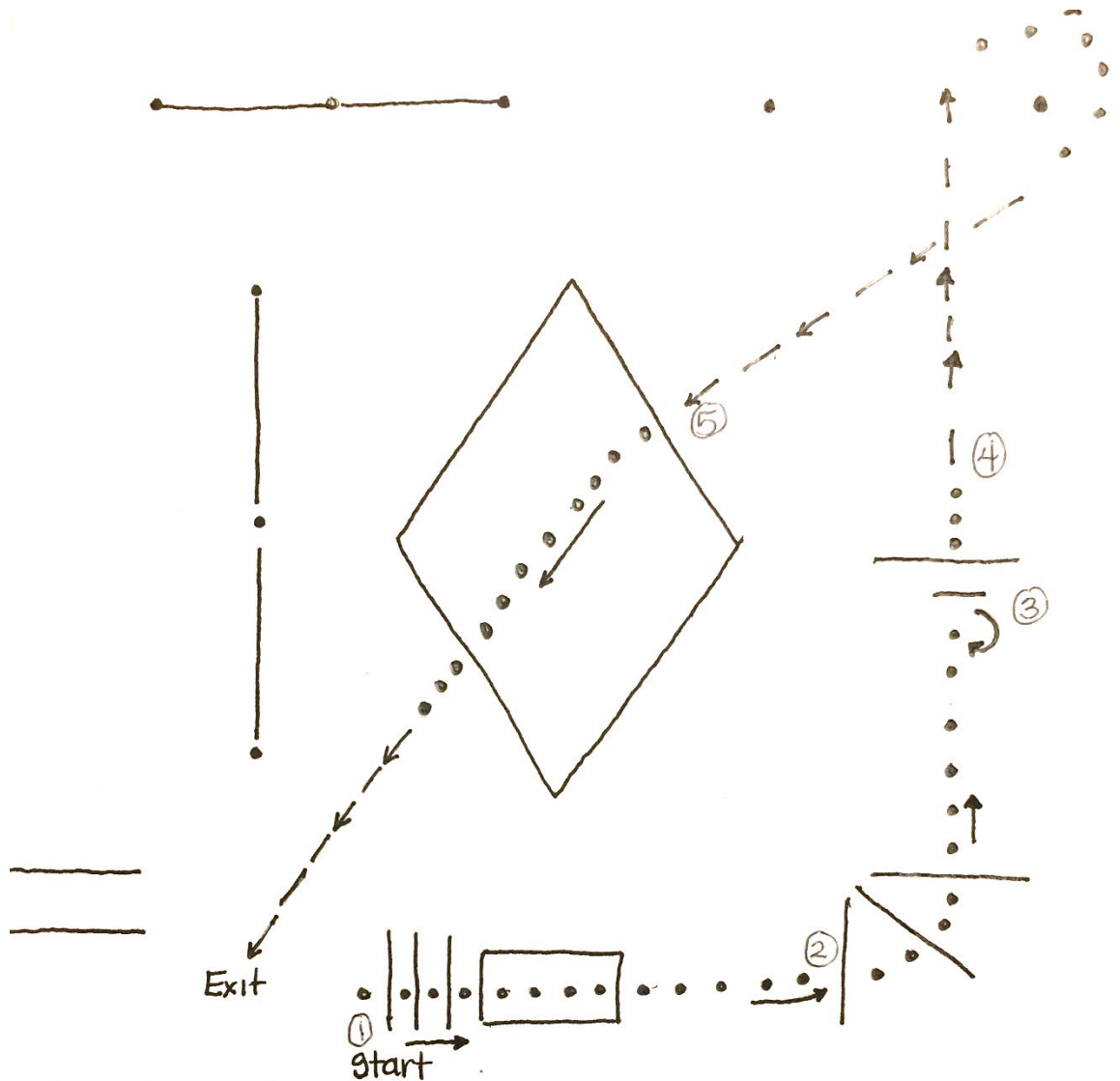

- ① walk over logs and bridge
- ② walk over Fan Logs
- ③ walk to single log stop, 360° turn to Right, walk over log.
- ④ Trot/jog to cone walk around Cone, trot/jog to box
- ⑤ walk through the Box.
- ⑥ Trot/jog to exit.

Lead Line Ground Poles

Therapeutic Maximum Ground Poles

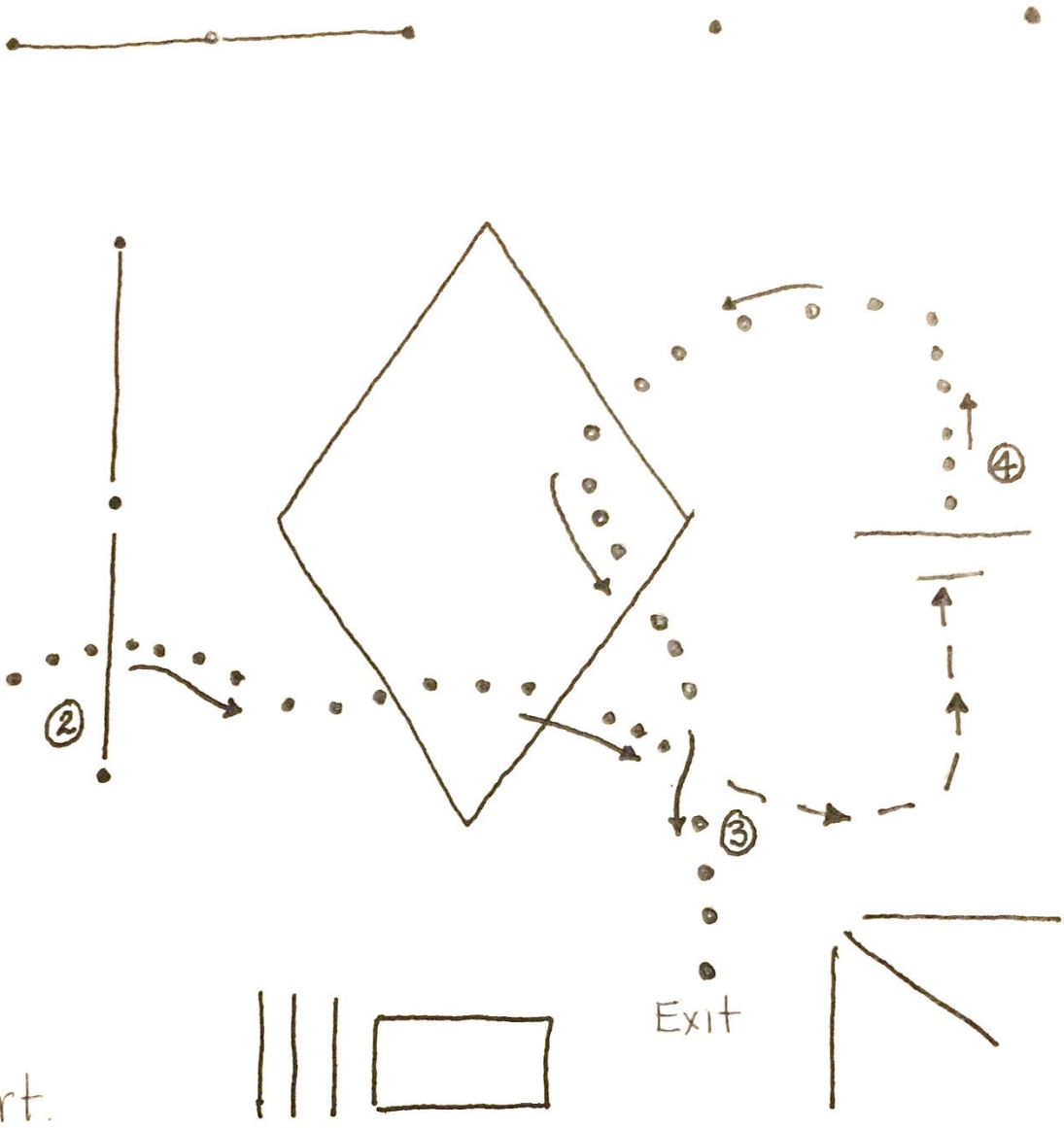

- ① Walk over two logs
- ② Walk over single log and over the corner of the Box
- ③ Trot/Jog to single log and Stop.
- ④ Walk over rail, continue over the corner of the Box And walk to exit.